

NOTES:
 1 MATERIAL:
 HOUSING: THERMOPLASTIC, UL 94V-0, BLACK;
 CONTACT: COPPER ALLOY
 2 FINISH:
 CONTACT: Ni: 50~120 u", Sn 80~240 u"
 SPECIFICATIONS:
 VOLTAGE RATING: AC/DC 250V
 CURRENT RATING: 2A PER PIN
 INSULATION RESISTANCE: 10OHM MIN
 CONTACT RESISTANCE: 30mΩ Max.
 OPERATION TEMPERATURE: -40° TO +85°
 3 DIMENSIONS WITH MARK " " INDICATE THE CRITICAL DIMENSIONS

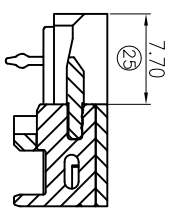

SECTION F-F
SCALE 1:1

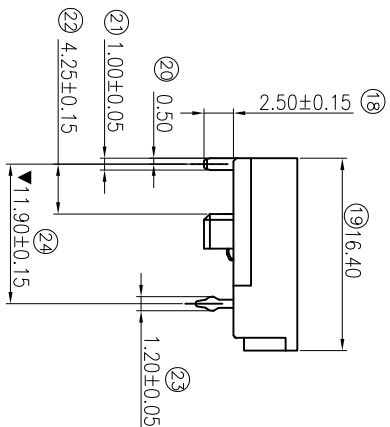
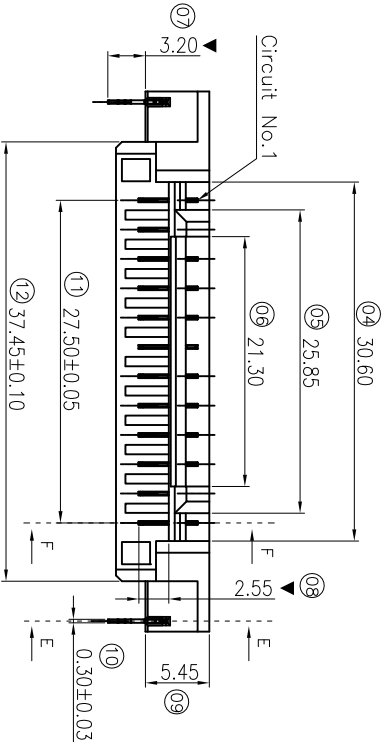
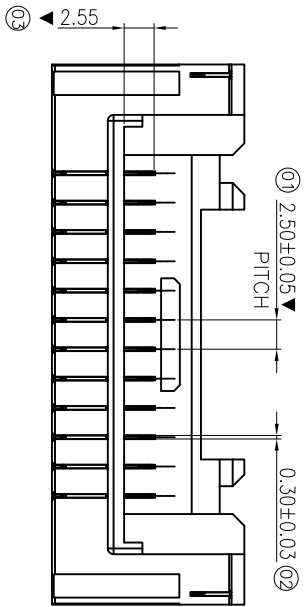
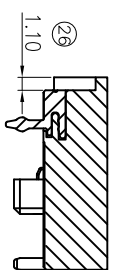

SECTION E-E
SCALE 1:1

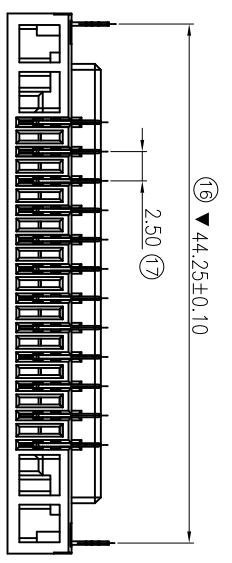
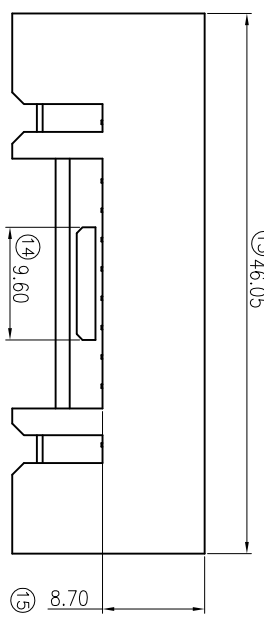

ITEM	NAME	QTY	MATERIAL	PLATING OR CLOCR
1	HOLD DOWN	2	BRASS T=0.30mm	Ni 50~120u" Sn 80~240u"
2	CONTACT	12	BRASS T=0.30mm	Ni 50~120u" Sn 80~240u"
3	HOUSING	1	LCP, UL94V-0	BLACK CLOCK

GENERAL TOLERANCE		DRAW:	
X: ±0.20	X': ±2.00'	CHECKED:	PART NO. B75-BR121550
.X: ±0.15	.X': ±1.00'	APPROVE:	NAME: BTW 12P 5.45H CONNECTOR
.XX: ±0.10	.XX': ±0.5'	DRAWING NO. A-B75-0001	
.XXX: ±0.05	.XXX': ±0.5'		

REV.	ECN NO.	DESCRIPTION	DATE	REV.	SHEET	TITLE	FINISH	SEE NOTE
A	E1802056A	转正式版本	2018.02.26	A	1/2	Assembly drawing		

昆山捷皇电子科技有限公司